

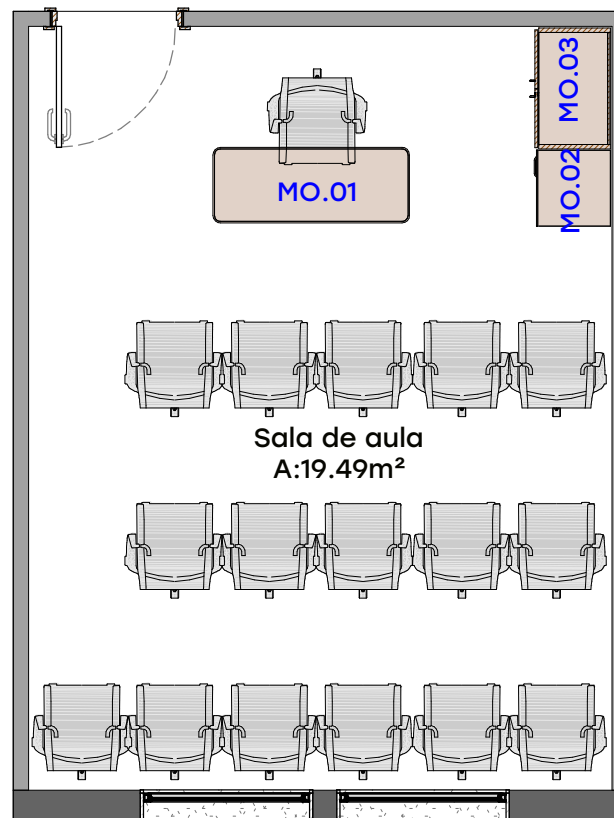

Sala de Entrevista . UTI Geral
ESCALA 1 : 50

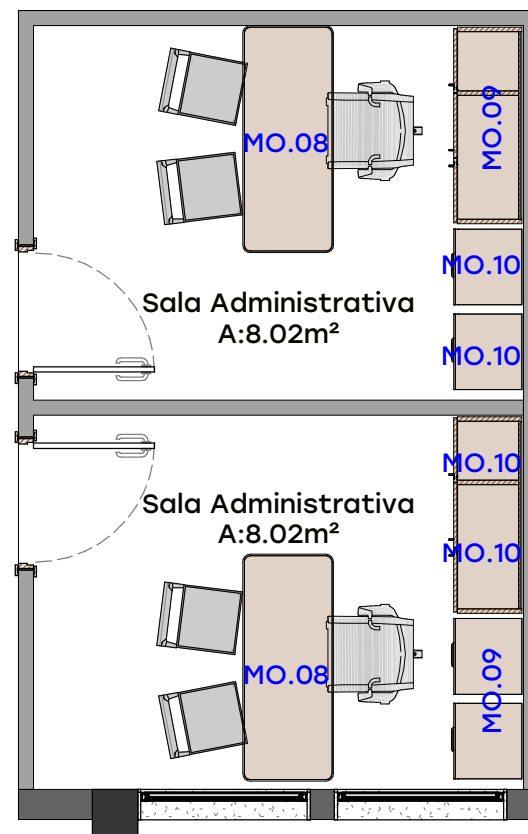

Salas de Aula . UTI Geral
ESCALA 1 : 50



Sala Administrativa . UTI Geral
ESCALA 1 : 50

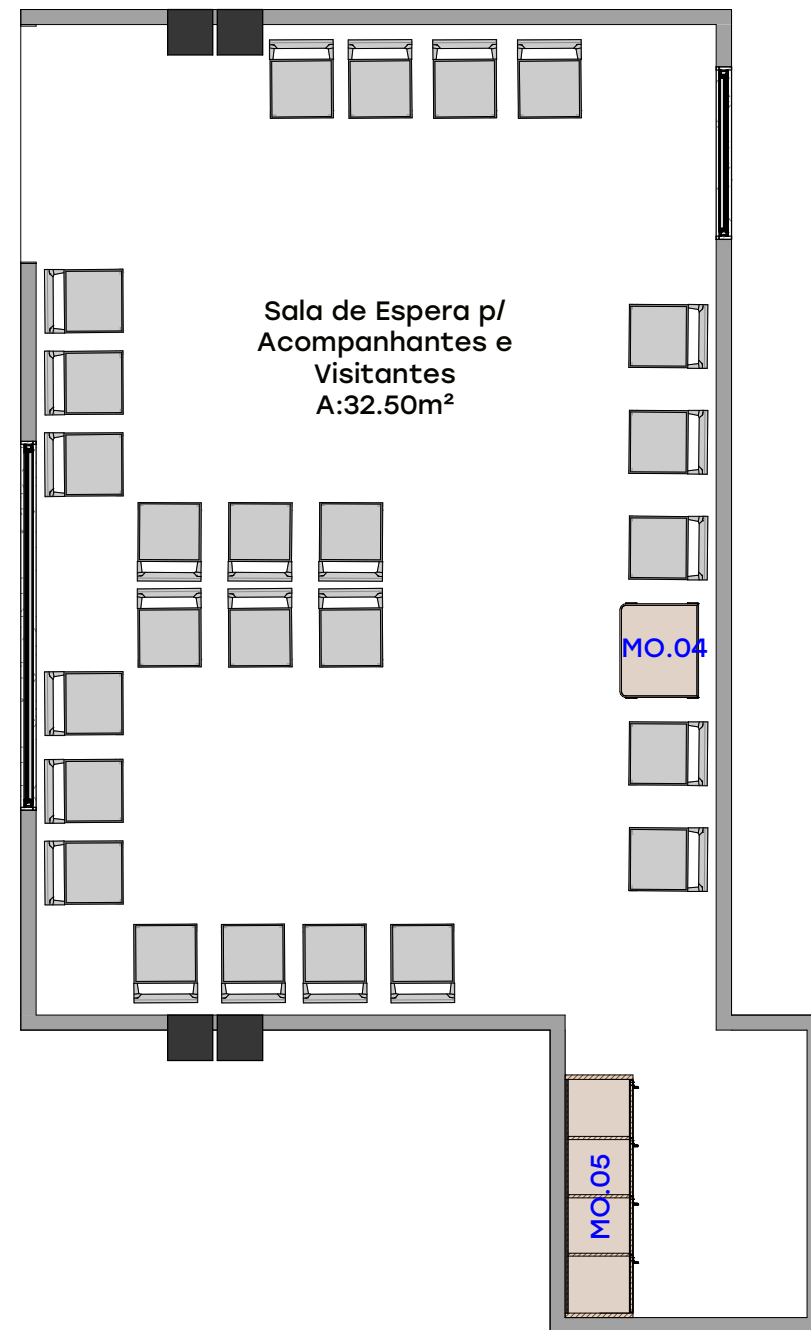

Sala de Espera . UTI Geral
ESCALA 1 : 50

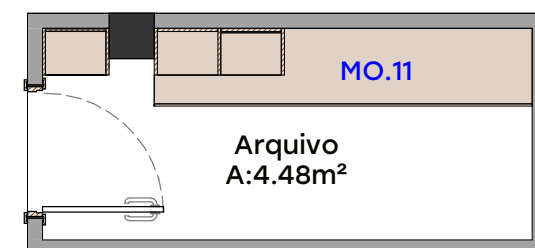

Arquivo . UTI Geral
ESCALA 1 : 50